

■ **SW6500/TASTY 6500** outdoor use DUCATI **RADIO ROLLING CODED KEYPAD** works on 433,92MHz frequency

■ By digiting a 4 digit codes + ENTER the keypad will transmit a rolling coded radio signal to command your door opener.

Fix the keypad on wall or pillar. It's recommended to place where it can be protected from rain even if it's suitable for outdoor use. It must be installed at a maximal distance of 10m from the electronic board of the opener. The keypad is supplied with a standard code =1111.

It is recommended to replace the standard code with a personal secret 4 digit code before to store the keypad in the electronic board's memory. it is possible to memorize max. 10 different personal code.

The Keypad are 1 channels only. Any of the memorized personal coded will all be used to transmit on the same channel (each single channel keypad can command 1 opener only)

Warning : it is extremely important to write down each personal code. because if it is forgotten the keypad could not be reseted and it will be unusefull.

Warning : in case of digiting a faulty code for 3 times the keypad will turn into in stand-by for 10 minutes . Durring this stand-by time it wont accept any further digiting. Wait 10 minutes befor to try again to insert the correct code.

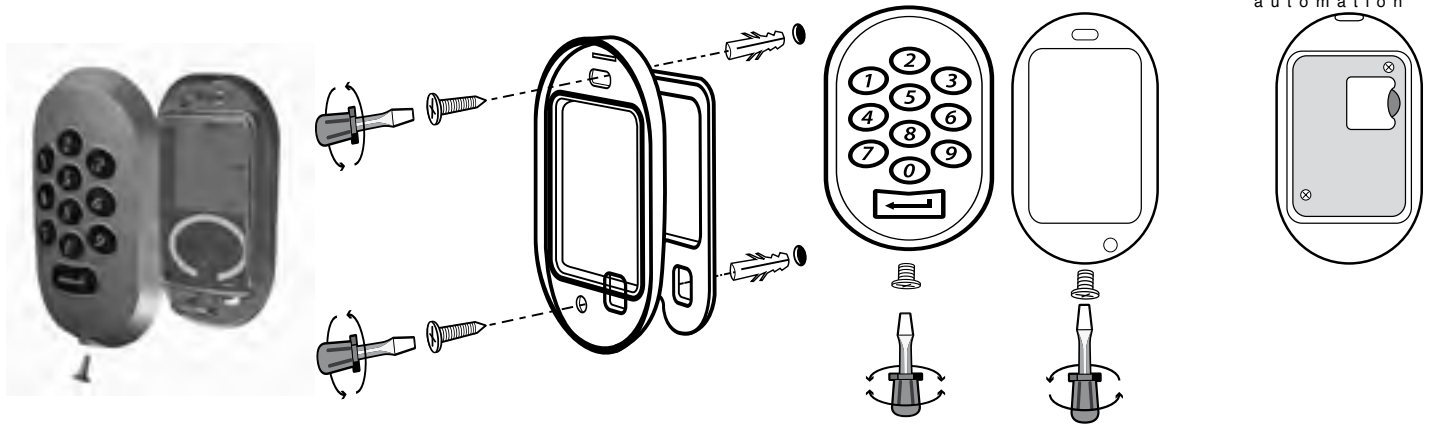

1) How to replace the standard code with a personalized 4 digit code (first operation)

digit the standard code 1111 + 3 + the 4 digit of the choosen personal code + ENTER. The keypad will make a BEEP to confirm that standard code has been replaced. ATTENTION: it is extremely important to write down the personal code. In case it is forgotten the keypad cannot not be reseted by the customer and it will be unusefull. If hthis occurs it must be shipped back to the manufacturer to be reseted. Costs will be at the charge of user.

A) To memorize the Keypad code in the electronic panel of the opener:

The door must be closed and idle.

- Press button P1 on the electronic board. The red LED switches on.

- Release button P1 and immediately on the keyswitch positioned by the electronic board digit the 4 personal code + ENTER (hold enter for about 1,5sec. at least) until the keypad confirms with a "beep". Hold the red LED light on the electronic board will quickly blink to show the procedure has been completed.

Warning: The memory of the electronic board of your opener can store up to 10-20 codes depending on the model (check the capacity of your memory card). If you need a larger number of remote controls is available an optional external receiver (RIX6040 o RIXI 6043)

To operate your gate you must digit on your KEYPAD your personal code + ENTER (hold enter for about 1,5sec. at least)

2) How to replace a persoanl code with a new personal code:

digit the personal code you wish to be replaced + 4 + the four digits of the new personal code + ENTER.

The keypad will make a BEEP to confirm that the personal code has been replaced.

3) HOW to add a new 4 digit code (without delating the previously setted 4 digit codes):

digit one of the previously setted 4 digit codes+ 3 + the new 4 digit code + ENTER The keypad will make a BEEP to confirm

4) How to delate a specic 4-digit code from the keypad

digit the code you want to delate + 5 + ENTER, the LED on the keypad will start blinking, press again on ENTER (within 1,5sec.) and hold pressed until the LED blinks, then release Enter The keypad will make a BEEP to confirm

5) How to delate all the codes setted in the keypad (all codes will be delated)

digit one of the previously setted 4 digit codes+ 6 + ENTER. The LED on the keypad will start blinking, press again on ENTER (within 1,5sec.) and hold pressed until the LED blinks, then release Enter .The keypad will make a BEEP to confirm the procedure has been compleeted.

WARNING: the Keypad will go back to the standard code =1111 but with this standard code it will not be possible to command anymore the opener. It will be necessary to re-set a new personalized code following instructions of point 1 above.

B) To erase your KEYPAD from the control board of your opener:

To deactivate any unwanted remote, erase its memory from the electronic board of your opener as following (all remote control codes memorized will be delated):

- The door must be closed and idle.

- Press button P1 for about 20 sec. until the red LED blinks

- Release P1.

- All remote control codes have been delated.- Reprogram each remote you wish to use following procedure on point A)